

LIMITED ASBESTOS IN BUILDING SURVEY

OF

FORMER PAYLESS SHOES
U.S. HIGHWAY 83 AND REDWOOD STREET
RIO GRANDE CITY, TEXAS

FOR

DERRICK MERCHANT, PRESIDENT
7B BUILDING & DEVELOPMENT
13105 CR 1820,
LUBBOCK, TEXAS 79424

BY



January 7, 2019

Table Of Contents

Conditions Discovered

Recommendations and Signatures

Homogenous Areas Inventory

Homogeneous Areas and ACM by Rooms

Floor plans/Sample locations

Lab Results

Licenses

CONDITIONS DISCOVERED

ASBESTOS CONTAINING MATERIALS DISCOVERED:

Asbestos Containing Materials (ACM), materials with greater than 1% asbestos content, was not discovered during the limited survey of the former Payless Shoes Store building at the corner of U.S. Highway 83 and Redwood Street in Rio Grande City, Texas. No materials were identified to contain asbestos above the regulatory threshold of greater than 1%.

HA ID	PHYSICAL DESCRIPTION	ACM STATUS	ESTIMATED QTY.	UOM
None Identified				

HOMOGENEOUS AREAS IDENTIFIED:

During the inspection the inspector identified the homogeneous areas (HA ID) listed in the "Homogeneous Areas Inventory" section of this report. Thirty-five samples were collected and shipped to an accredited laboratory for analysis by Polarized Light Microscopy (PLM). None of the samples were identified to contain asbestos by PLM. Therefore, none of the homogeneous areas were identified to contain asbestos above the regulatory standard. There were no "Presumed Asbestos Containing Materials."

SPECIAL CONDITIONS:

Roofing was not disturbed or tested during this inspection to avoid water intrusion issues. Current roofing appears to be single ply membrane roofing based on Google Earth images. If correct the membrane would be vinyl or rubber and; therefore, not a suspect material. If roofing is not single ply membrane and is to be disturbed due to renovation or demolition then additional inspection would be required. Alternately, roofing could be presumed ACM and removed in compliance with NESHAP regulation requiring the presence of a competent person during removal operations.

RECOMMENDATIONS AND SIGNATURES

RECOMMENDATIONS:

Environmental Services Agency recommends the following actions based on the conditions discovered during the inspection.

- Based on the findings of this inspection no further action is required by regulations governing asbestos.
- If new or previously undiscovered materials are discovered additional inspection and sampling would be required prior to renovation or demolition activities.

CERTIFICATIONS:

Environmental Services Agency, a licensed Asbestos Consulting Agency, certifies that this report represents the conditions discovered at the time of inspection. The survey was conducted by Terry L. Adams, a licensed Asbestos Consultant. The inspection data and report were reviewed by Terry L. Adams, a licensed Asbestos Consultant. "The asbestos survey to which this statement is attached is an accurate presentation of the findings of the investigation."



Terry L. Adams

License # 10-5683

January 7, 2019

INTENT OF SURVEY:

The building's owner chose to comply with current asbestos regulations under Federal and State law. The National Emissions Standard for Hazardous Air Pollutants (NESHAP 40 CFR 61), and the "Texas Asbestos Health Protection Rules" (TAC 295) apply to the owner's facility. The owner selected Environmental Services Agency, to conduct the asbestos in building survey. The survey was designed to identify asbestos containing materials (ACM) that require removal before repairs, renovations or demolitions. The survey contains information required to be communicated by the owner to employees, occupants, and workers at the facility under OSHA rules found at 29 CFR 1926.1101. This survey by itself does not constitute a management plan, operations and maintenance plan, and is not intended to be used as a risk assessment.

METHODOLOGY:

During the survey the inspector identified those materials which through the inspector's past experience and training in asbestos material identification should be considered suspect asbestos containing materials. Samples of these materials were collected for laboratory analysis.

The inspection was limited to exclude roofing to avoid creating roof leaks. Additionally, the roofing currently in place appeared to be a non-suspect material.

This report outlines the conditions discovered, suspect materials selected for sampling, the asbestos containing materials discovered, and recommendations as related to addressing ACM during construction. The survey will not address managing any asbestos containing materials discovered nor specifically require their abatement.

HOMOGENEOUS AREAS INVENTORY

HA ID	PHYSICAL DESCRIPTION	ACM STATUS	ESTIMATED QTY.	UOM
C01	SAT, 24" x 48" fissured and perforated	Negative	2440	S.F.
C02	SAT, 24" x 48" perforated	Negative	1250	S.F.
F01	RFT, 12" x 12" off white with dark accts with mastic	Negative	800	S.F.
F02	CER, 8" x 8" gray with grout and mortar	Negative	800	S.F.
I01	TBI, fiberglass batt, paper back	Negative	5800	S.F.
M01	EFIS, cementitious covering with fiberglass over foam	Negative	5240	S.F.
M02	MISC, caulk, black	Negative	240	L.F.
M03	MISC, caulk, gray, exterior at bottom of EFIS	Negative	160	L.F.
W01	DW, tape and bedding	Negative	10500	S.F.
W02	DW, texture painted	Negative	2360	S.F.
W03	RB, vinyl with mastic	Negative	165	L.F.

HOMOGENEOUS AREAS AND ACM BY ROOMS

ROOM ID	HA ID	PHYSICAL DESCRIPTION	ACM STATUS	TESTED OR PRESUMED
101	C01	SAT, 24" x 48" fissured and perforated	Negative	Tested
	C02	SAT, 24" x 48" perforated	Negative	Tested
	F02	CER, 8" x 8" gray with grout and mortar	Negative	Tested
	I01	TBI, fiberglass batt, paper back	Negative	Tested
	W01	DW, tape and bedding	Negative	Tested
	W02	DW, texture painted	Negative	Tested
	W03	RB, vinyl with mastic	Negative	Tested
102	C01	SAT, 24" x 48" fissured and perforated	Negative	Tested
	C02	SAT, 24" x 48" perforated	Negative	Tested
	F01	RFT, 12" x 12" off white with dark accts with mastic	Negative	Tested
	I01	TBI, fiberglass batt, paper back	Negative	Tested
	W01	DW, tape and bedding	Negative	Tested
	W02	DW, texture painted	Negative	Tested
	W03	RB, vinyl with mastic	Negative	Tested
103	C01	SAT, 24" x 48" fissured and perforated	Negative	Tested
	C02	SAT, 24" x 48" perforated	Negative	Tested
	F01	RFT, 12" x 12" off white with dark accts with mastic	Negative	Tested
	I01	TBI, fiberglass batt, paper back	Negative	Tested
	W01	DW, tape and bedding	Negative	Tested
	W02	DW, texture painted	Negative	Tested
	W03	RB, vinyl with mastic	Negative	Tested
Ext.	M01	EFIS, cementitious covering with fiberglass over foam	Negative	Tested
	M02	MISC, caulk, black	Negative	Tested
	M03	MISC, caulk, gray, exterior at bottom of EFIS	Negative	Tested

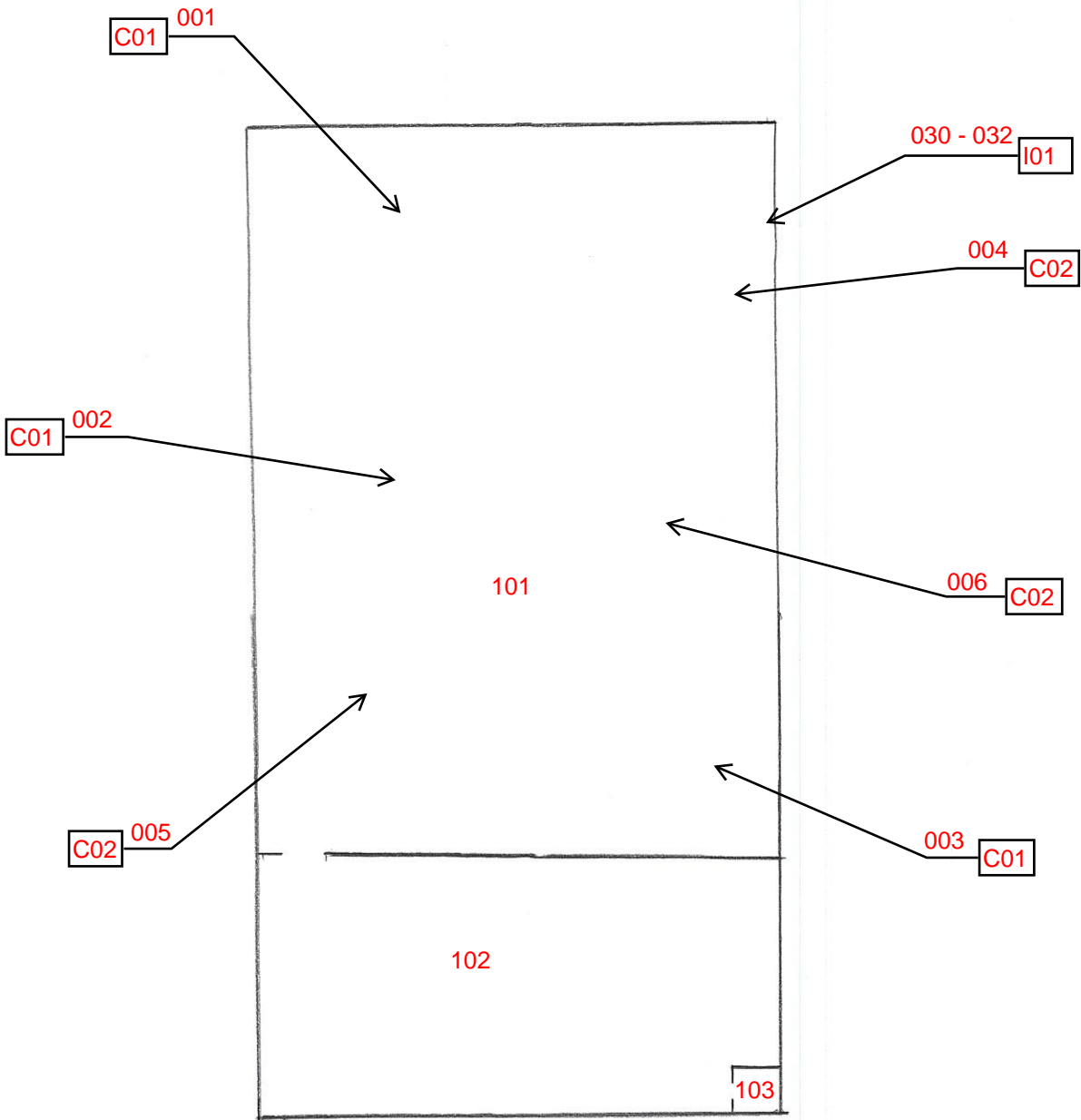

Former Payless Shoes
Rio Grande City Texas



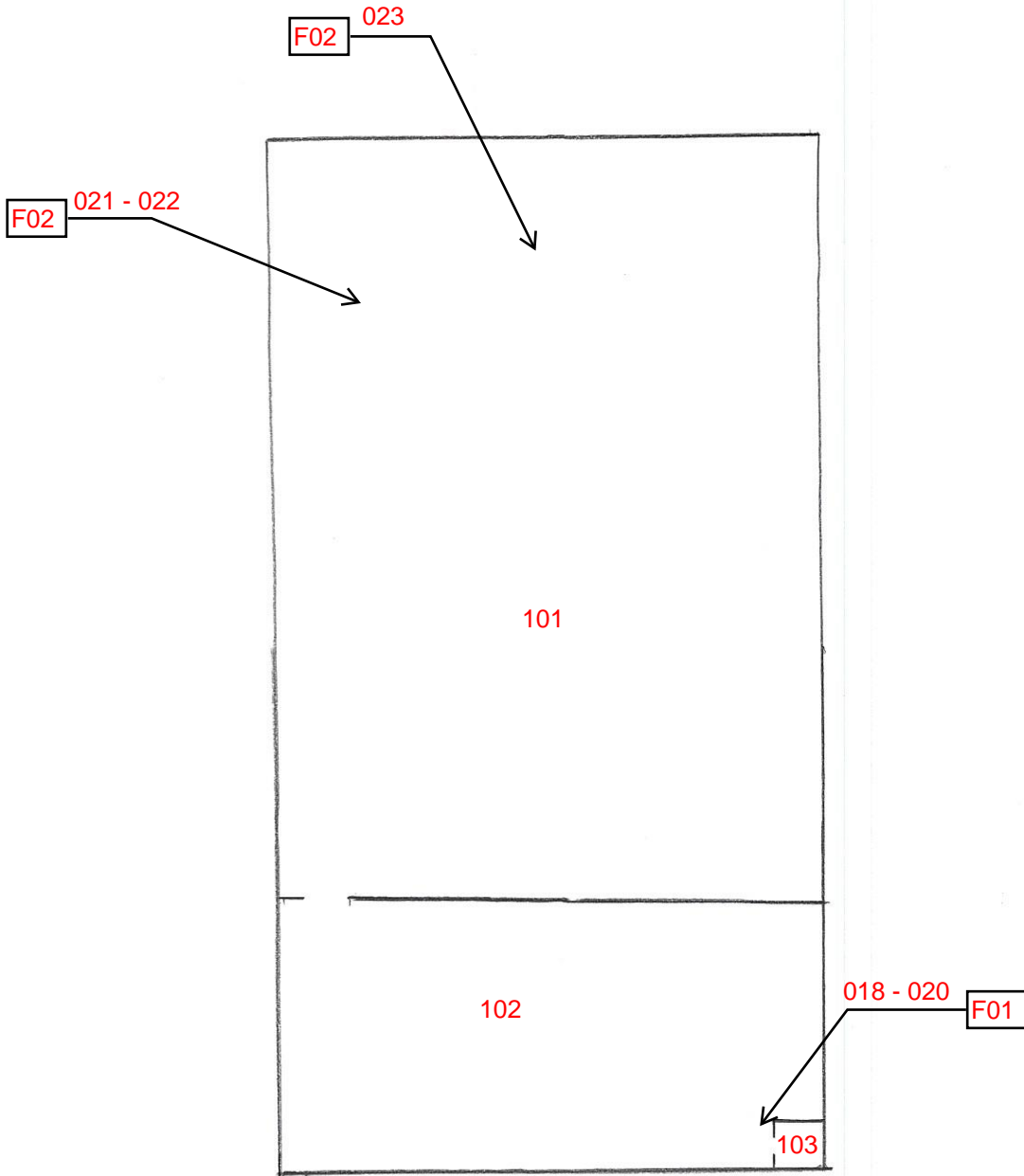

Former Payless Shoes
Rio Grande City Texas



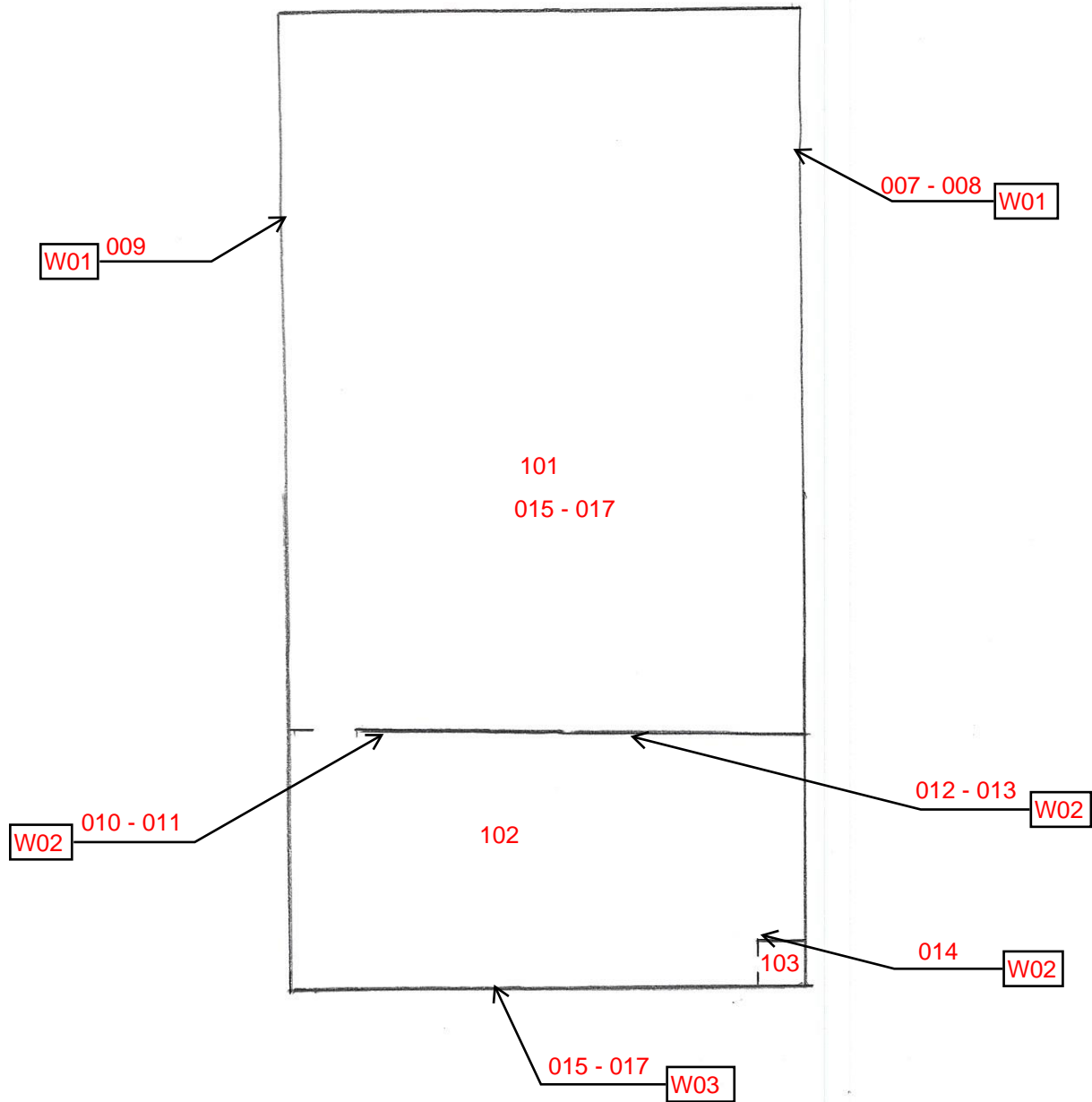

Former Payless Shoes
Rio Grande City Texas



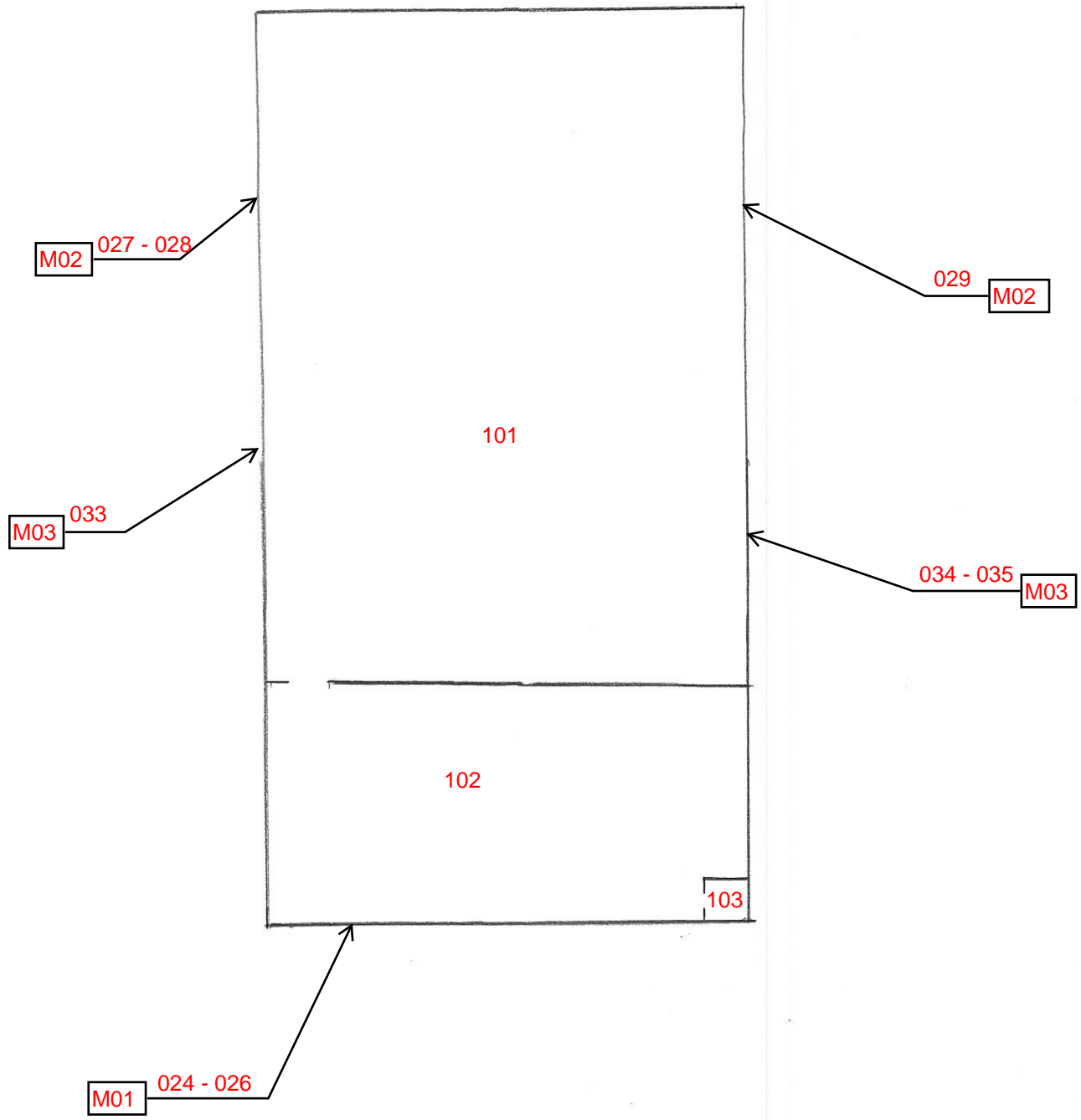

Former Payless Shoes
Rio Grande City Texas





Bulk Asbestos Fiber Analysis by Polarized Light Microscopy (PLM)

EPA 600/M4-82-020; 600/R-93/116

Terry Adams
 Environmental Services Agency
 P.O. Box 94182
 Lubbock TX 79493

J3 Order #: JH19104794
 Project #: 18058AI
 Date Received: 03-Jan-2019
 Date Analyzed: 03-Jan-2019
 Date Reported: 04-Jan-2019

Payless Rio Grande City TX

Sample ID #	Sample Description	Asbestos Constituents	Non-Asbestos Constituents
001	Ceiling Tile, White/ Gray, Homogeneous	None Detected	Cellulose Fiber 40% Mineral Wool 40% Non-Fibrous Material 20%
002	Ceiling Tile, White/ Gray, Homogeneous	None Detected	Cellulose Fiber 40% Mineral Wool 40% Non-Fibrous Material 20%
003	Ceiling Tile, White/ Gray, Homogeneous	None Detected	Cellulose Fiber 40% Mineral Wool 40% Non-Fibrous Material 20%
004	Ceiling Tile, White/ Gray, Homogeneous	None Detected	Cellulose Fiber 40% Mineral Wool 40% Non-Fibrous Material 20%
005	Ceiling Tile, White/ Gray, Homogeneous	None Detected	Cellulose Fiber 40% Mineral Wool 40% Non-Fibrous Material 20%
006	Ceiling Tile, White/ Gray, Homogeneous	None Detected	Cellulose Fiber 40% Mineral Wool 40% Non-Fibrous Material 20%

Jovahny Dominguez Analyst

 Scott Ward, Ph.D. Lab Director

This report relates only to the materials tested. This report is for the exclusive use of the addressed client and shall not be reproduced except in full, without written approval by J3 Resources, Inc. (J3). Samples are analyzed according to the methods listed above and are subject to the inherent limitations of PLM and interference of matrix components. Reporting limit for the above method is a function of the quantity of sample analyzed, matrix interference, sample preparation, fiber size, and distribution. Asbestos may be detected in concentrations of <1% by area if sufficient material is analyzed. J3 recommends TEM confirmation of soils, vermiculite and non-friable organically bound materials (NOB) reported as None Detected or < 1% Asbestos by PLM. All samples received in good condition unless otherwise noted. This report shall not be used to claim product approval, certification, or endorsement by NVLAP, NIST, or any agency of the federal government.



Bulk Asbestos Fiber Analysis by Polarized Light Microscopy (PLM)

EPA 600/M4-82-020; 600/R-93/116

Terry Adams
 Environmental Services Agency
 P.O. Box 94182
 Lubbock TX 79493

J3 Order #: JH19104794
 Project #: 18058AI
 Date Received: 03-Jan-2019
 Date Analyzed: 03-Jan-2019
 Date Reported: 04-Jan-2019

Payless Rio Grande City TX

Sample ID #	Sample Description	Asbestos Constituents	Non-Asbestos Constituents	
007	LAYER 1 Texture, White, Homogeneous	None Detected	Non-Fibrous Material	100%
	LAYER 2 Tape, Beige, Homogeneous	None Detected	Cellulose Fiber	100%
	LAYER 3 Joint Compound, White, Homogeneous	None Detected	Non-Fibrous Material	100%
	LAYER 4 Wallboard, Brown/ White, Homogeneous	None Detected	Cellulose Fiber Non-Fibrous Material	10% 90%
008	LAYER 1 Texture, White, Homogeneous	None Detected	Non-Fibrous Material	100%
	LAYER 2 Tape, Beige, Homogeneous	None Detected	Cellulose Fiber	100%
	LAYER 3 Joint Compound, White, Homogeneous	None Detected	Non-Fibrous Material	100%
	LAYER 4 Wallboard, Brown/ White, Homogeneous	None Detected	Cellulose Fiber Non-Fibrous Material	10% 90%
009	LAYER 1 Texture, White, Homogeneous	None Detected	Non-Fibrous Material	100%
	LAYER 2 Tape, Beige, Homogeneous	None Detected	Cellulose Fiber	100%
	LAYER 3 Joint Compound, White, Homogeneous	None Detected	Non-Fibrous Material	100%
	LAYER 4 Wallboard, Brown/ White, Homogeneous	None Detected	Cellulose Fiber Non-Fibrous Material	10% 90%

Jovahny Dominguez Analyst

 Scott Ward, Ph.D. Lab Director

This report relates only to the materials tested. This report is for the exclusive use of the addressed client and shall not be reproduced except in full, without written approval by J3 Resources, Inc. (J3). Samples are analyzed according to the methods listed above and are subject to the inherent limitations of PLM and interference of matrix components. Reporting limit for the above method is a function of the quantity of sample analyzed, matrix interference, sample preparation, fiber size, and distribution. Asbestos may be detected in concentrations of <1% by area if sufficient material is analyzed. J3 recommends TEM confirmation of soils, vermiculite and non-friable organically bound materials (NOB) reported as None Detected or < 1% Asbestos by PLM. All samples received in good condition unless otherwise noted. This report shall not be used to claim product approval, certification, or endorsement by NVLAP, NIST, or any agency of the federal government.



Bulk Asbestos Fiber Analysis by Polarized Light Microscopy (PLM)

EPA 600/M4-82-020; 600/R-93/116

Terry Adams
Environmental Services Agency
P.O. Box 94182
Lubbock TX 79493

J3 Order #: JH19104794
Project #: 18058AI
Date Received: 03-Jan-2019
Date Analyzed: 03-Jan-2019
Date Reported: 04-Jan-2019

Payless Rio Grande City TX

Sample ID #	Sample Description	Asbestos Constituents	Non-Asbestos Constituents	
010	LAYER 1 Texture, White, Homogeneous	None Detected	Non-Fibrous Material	100%
	LAYER 2 Wallboard, Brown/ White, Homogeneous	None Detected	Cellulose Fiber Non-Fibrous Material	10% 90%
011	LAYER 1 Texture, White, Homogeneous	None Detected	Non-Fibrous Material	100%
	LAYER 2 Wallboard, Brown/ White, Homogeneous	None Detected	Cellulose Fiber Non-Fibrous Material	10% 90%
012	Painted Wallboard, Brown/ White, Homogeneous	None Detected	Cellulose Fiber Non-Fibrous Material	10% 90%
013	LAYER 1 Texture, White, Homogeneous	None Detected	Non-Fibrous Material	100%
	LAYER 2 Wallboard, Brown/ White, Homogeneous	None Detected	Cellulose Fiber Non-Fibrous Material	10% 90%
014	LAYER 1 Texture, White, Homogeneous	None Detected	Non-Fibrous Material	100%
	LAYER 2 Wallboard, Brown/ White, Homogeneous	None Detected	Cellulose Fiber Non-Fibrous Material	10% 90%
015	LAYER 1 Cove Base, Black, Homogeneous	None Detected	Non-Fibrous Material	100%
	LAYER 2 Mastic, Beige, Homogeneous	None Detected	Non-Fibrous Material	100%

Jovahny Dominguez Analyst

 Scott Ward, Ph.D. Lab Director

This report relates only to the materials tested. This report is for the exclusive use of the addressed client and shall not be reproduced except in full, without written approval by J3 Resources, Inc. (J3). Samples are analyzed according to the methods listed above and are subject to the inherent limitations of PLM and interference of matrix components. Reporting limit for the above method is a function of the quantity of sample analyzed, matrix interference, sample preparation, fiber size, and distribution. Asbestos may be detected in concentrations of <1% by area if sufficient material is analyzed. J3 recommends TEM confirmation of soils, vermiculite and non-friable organically bound materials (NOB) reported as None Detected or < 1% Asbestos by PLM. All samples received in good condition unless otherwise noted. This report shall not be used to claim product approval, certification, or endorsement by NVLAP, NIST, or any agency of the federal government.



Bulk Asbestos Fiber Analysis by Polarized Light Microscopy (PLM)

EPA 600/M4-82-020; 600/R-93/116

Terry Adams
 Environmental Services Agency
 P.O. Box 94182
 Lubbock TX 79493

J3 Order #: JH19104794
 Project #: 18058AI
 Date Received: 03-Jan-2019
 Date Analyzed: 03-Jan-2019
 Date Reported: 04-Jan-2019

Payless Rio Grande City TX

Sample ID #	Sample Description	Asbestos Constituents	Non-Asbestos Constituents	
016	LAYER 1 Cove Base, Black, Homogeneous	None Detected	Non-Fibrous Material	100%
	LAYER 2 Mastic, Beige, Homogeneous	None Detected	Non-Fibrous Material	100%
017	LAYER 1 Cove Base, Black, Homogeneous	None Detected	Non-Fibrous Material	100%
	LAYER 2 Mastic, Beige, Homogeneous	None Detected	Non-Fibrous Material	100%
018	LAYER 1 Floor Tile, Tan, Homogeneous	None Detected	Non-Fibrous Material	100%
	LAYER 2 Mastic, Yellow, Homogeneous	None Detected	Non-Fibrous Material	100%
019	LAYER 1 Floor Tile, Tan, Homogeneous	None Detected	Non-Fibrous Material	100%
	LAYER 2 Mastic, Yellow, Homogeneous	None Detected	Non-Fibrous Material	100%
020	LAYER 1 Floor Tile, Tan, Homogeneous	None Detected	Non-Fibrous Material	100%
	LAYER 2 Mastic, Yellow, Homogeneous	None Detected	Non-Fibrous Material	100%
021	LAYER 1 Ceramic Tile, Gray, Homogeneous	None Detected	Non-Fibrous Material	100%
	LAYER 2 Grout, Gray, Homogeneous	None Detected	Non-Fibrous Material	100%
	LAYER 3 Mortar, Gray, Homogeneous	None Detected	Non-Fibrous Material	100%

Jovahny Dominguez Analyst

 Scott Ward, Ph.D. Lab Director

This report relates only to the materials tested. This report is for the exclusive use of the addressed client and shall not be reproduced except in full, without written approval by J3 Resources, Inc. (J3). Samples are analyzed according to the methods listed above and are subject to the inherent limitations of PLM and interference of matrix components. Reporting limit for the above method is a function of the quantity of sample analyzed, matrix interference, sample preparation, fiber size, and distribution. Asbestos may be detected in concentrations of <1% by area if sufficient material is analyzed. J3 recommends TEM confirmation of soils, vermiculite and non-friable organically bound materials (NOB) reported as None Detected or < 1% Asbestos by PLM. All samples received in good condition unless otherwise noted. This report shall not be used to claim product approval, certification, or endorsement by NVLAP, NIST, or any agency of the federal government.



Bulk Asbestos Fiber Analysis by Polarized Light Microscopy (PLM)

EPA 600/M4-82-020; 600/R-93/116

Terry Adams
 Environmental Services Agency
 P.O. Box 94182
 Lubbock TX 79493

J3 Order #: JH19104794
 Project #: 18058AI
 Date Received: 03-Jan-2019
 Date Analyzed: 03-Jan-2019
 Date Reported: 04-Jan-2019

Payless Rio Grande City TX

Sample ID #	Sample Description	Asbestos Constituents	Non-Asbestos Constituents	
022	LAYER 1 Ceramic Tile, Gray, Homogeneous	None Detected	Non-Fibrous Material	100%
	LAYER 2 Grout, Gray, Homogeneous	None Detected	Non-Fibrous Material	100%
	LAYER 3 Mortar, Gray, Homogeneous	None Detected	Non-Fibrous Material	100%
023	LAYER 1 Ceramic Tile, Gray, Homogeneous	None Detected	Non-Fibrous Material	100%
	LAYER 2 Grout, Gray, Homogeneous	None Detected	Non-Fibrous Material	100%
	LAYER 3 Mortar, Gray, Homogeneous	None Detected	Non-Fibrous Material	100%
024	EFIS, Gray, Homogeneous	None Detected	Fibrous Glass Non-Fibrous Material	15% 85%
025	EFIS, Gray, Homogeneous	None Detected	Fibrous Glass Non-Fibrous Material	15% 85%
026	EFIS, Gray, Homogeneous	None Detected	Fibrous Glass Non-Fibrous Material	15% 85%
027	Caulk, Black, Homogeneous	None Detected	Synthetic Fiber Non-Fibrous Material	5% 95%
028	Caulk, Black, Homogeneous	None Detected	Synthetic Fiber Non-Fibrous Material	5% 95%

Jovahny Dominguez Analyst

 Scott Ward, Ph.D. Lab Director

This report relates only to the materials tested. This report is for the exclusive use of the addressed client and shall not be reproduced except in full, without written approval by J3 Resources, Inc. (J3). Samples are analyzed according to the methods listed above and are subject to the inherent limitations of PLM and interference of matrix components. Reporting limit for the above method is a function of the quantity of sample analyzed, matrix interference, sample preparation, fiber size, and distribution. Asbestos may be detected in concentrations of <1% by area if sufficient material is analyzed. J3 recommends TEM confirmation of soils, vermiculite and non-friable organically bound materials (NOB) reported as None Detected or < 1% Asbestos by PLM. All samples received in good condition unless otherwise noted. This report shall not be used to claim product approval, certification, or endorsement by NVLAP, NIST, or any agency of the federal government.



Bulk Asbestos Fiber Analysis by Polarized Light Microscopy (PLM)

EPA 600/M4-82-020; 600/R-93/116

Terry Adams
 Environmental Services Agency
 P.O. Box 94182
 Lubbock TX 79493

J3 Order #: JH19104794
 Project #: 18058AI
 Date Received: 03-Jan-2019
 Date Analyzed: 03-Jan-2019
 Date Reported: 04-Jan-2019

Payless Rio Grande City TX

Sample ID #	Sample Description	Asbestos Constituents	Non-Asbestos Constituents	
029	Caulk, Black, Homogeneous	None Detected	Synthetic Fiber Non-Fibrous Material	5% 95%
030	LAYER 1 Tar Paper, Brown/ Black, Homogeneous	None Detected	Cellulose Fiber Non-Fibrous Material	80% 20%
	LAYER 2 Insulation, Pink, Homogeneous	None Detected	Mineral Wool Non-Fibrous Material	95% 5%
031	LAYER 1 Tar Paper, Brown/ Black, Homogeneous	None Detected	Cellulose Fiber Non-Fibrous Material	80% 20%
	LAYER 2 Insulation, Pink, Homogeneous	None Detected	Mineral Wool Non-Fibrous Material	95% 5%
032	LAYER 1 Tar Paper, Brown/ Black, Homogeneous	None Detected	Cellulose Fiber Non-Fibrous Material	80% 20%
	LAYER 2 Insulation, Pink, Homogeneous	None Detected	Mineral Wool Non-Fibrous Material	95% 5%
033	Caulk, Gray, Homogeneous	None Detected	Non-Fibrous Material	100%
034	Caulk, Gray, Homogeneous	None Detected	Non-Fibrous Material	100%
035	Caulk, Gray, Homogeneous	None Detected	Non-Fibrous Material	100%

Jovahny Dominguez Analyst

 Scott Ward, Ph.D. Lab Director

This report relates only to the materials tested. This report is for the exclusive use of the addressed client and shall not be reproduced except in full, without written approval by J3 Resources, Inc. (J3). Samples are analyzed according to the methods listed above and are subject to the inherent limitations of PLM and interference of matrix components. Reporting limit for the above method is a function of the quantity of sample analyzed, matrix interference, sample preparation, fiber size, and distribution. Asbestos may be detected in concentrations of <1% by area if sufficient material is analyzed. J3 recommends TEM confirmation of soils, vermiculite and non-friable organically bound materials (NOB) reported as None Detected or < 1% Asbestos by PLM. All samples received in good condition unless otherwise noted. This report shall not be used to claim product approval, certification, or endorsement by NVLAP, NIST, or any agency of the federal government.

LICENSES



**Texas Department of
State Health Services**

Asbestos Individual Consultant

TERRY L ADAMS

License No. 105683

Control No. 97237

Expiration Date: 8/7/2019

